



ACCESSORY

Pro Dunk® Boundary Netting System

OWNER'S MANUAL

Thank you for purchasing our Boundary Netting System. We try hard to ensure that our products are of high quality and free of manufacturing defects and of missing parts. However, if you have any problems with your Boundary Net, such as a manufacturing defect or a missing part please contact us at the following:

Toll Free: 1.888.600.8545

Pro Dunk®

Web: www.produnk.com

22047 Lutheran Church Rd.

Tomball, TX 77377

Support: www.produnk.com/support

Read this manual all the way through before starting assembly of your Boundary Net. Then read each step completely before beginning installation.

Safety Instructions



IMPORTANT

It is the responsibility of purchaser to ensure that all installers and players fully comply with the detailed instructions set forth in this product installation manual. Product assembly should be carried out exactly as instructed and owner supervision of use and installation is required to prevent risk of product malfunction or risk injury.

- All tools used to assemble this product should be used in compliance with manufacturer's guidelines.
- Installation of this product will require heavy lifting and bending. Any person that is not capable of such activity should not participate in the installation of this product.
- If using a ladder during assemble, use extreme caution and refer to the warnings and cautions on the ladder.
- Due to the size and weight of this product, we recommend at least (2) capable adults are present.
- Make sure there are no overhead power lines within a 35 foot radius of the boundary netting system.
- All parts and components necessary to complete proper installation are included within this product. Do not use parts not included with our system. Failure to follow this requirement could cause product malfunction and will void warranty of this product.
- Keep all organic materials away from parts and components to avoid corrosion.
- Never use your Boundary Net during rain or snow
- Your boundary netting is only designed for basketballs to come in contact with it. Do not let a person any other object come in contact with your netting system.

- Check the Boundary Netting System on a regular basis to ensure that there are no signs of deterioration or corrosion, loose hardware, or damaged parts. If you see any signs of damage contact Pro Dunk® for replacement parts or assistance.
- For maintenance repairs please contact a professional. produnk.com/installers
- **Failure to follow these safety instructions could result in product malfunction, serious injury, or even death.**

Pro Dunk® retains the right to modify this document at any time without notice or obligation.

Keep this installation manual as a reference for your safety and the safety of those playing on the basketball system. Additional copies of these safety instructions are available by calling customer service at **1-888.600.8545** or at **www.produnk.com/support**

Installation Overview

In order to have safe fun and a long use of your Boundary Net, please note and heed the following:

- 1) Prior to Boundary Net assembly, check for power lines within 35 feet of your basketball system. If power lines are within 35 feet of your boundary net do not continue.
- 2) Immediately unpack all components and cross check against bill of materials. Report any shortages to Pro Dunk® customer service at 1.888.600.8545.
- 3) For safety measures, have at least 2 capable persons to assist you in assembly of your Pro Dunk® Boundary Net.
- 4) Parts can be ordered at www.produnk.com/parts
- 5) Installation is a two part process.

PART 1

- Day 1.** Complete Anchor System Installation Instructions. (Below)
- Day 2.** Allow concrete to cure.
- Day 3** Allow concrete to cure.
- Day 4.** Allow concrete to cure.

PART 2

- Day 5.** Complete pole assembly



**Know what's below.
Call before you dig.**
www.Call811.com

White—Proposed Excavation

Pink—Temporary Survey Markings

Red—Electric Power Lines, Cables, Conduit, and Lighting Cables

Yellow—Gas, Oil, Petroleum, or Gaseous Materials

Orange—Communication, Alarm or Signal Lines, Cables or Conduit

Blue—Portable Water

Purple—Reclaimed Water, Irrigation and Slurry Lines

Green—Sewers and Drain Lines



Required Tools

- (2) Crescent Wrenches
- String Level System or Laser Level System
- Tape Measure
- Post Hole Digger and Shovel
- Wheel Barrow
- Ready Mix Concrete
 - Roughly [4] 80lb bags per anchor OR
 - Roughly [5] 60lb bags per anchor
- Water
- Trowel and Level
- (2) 8ft ladders
- Scissors (To Cut Zip Ties)

Socket/Wrench Sizes Recommended
<ul style="list-style-type: none">• 13mm• 17mm

Installation Video

Navigate to be below URL to watch our installation video.

www.produnk.com/video/boundary_netting_installation.html

This video shows a professional assembly team installing the Boundary Net. They go through each situation separately to give a complete picture no matter what configuration of the boundary net you purchased.



www.produnk.com/video/boundary_netting_installation.html

Day 1

ANCHOR SYSTEM INSTALLATION INSTRUCTIONS

WARNING

Before digging the hole for this pole, check for buried power, gas, water, and telecommunication lines! Failure to do so could result in serious or fatal injury! Contact your local utility company if unsure.

1) Installation Location

Position your anchors using the diagrams below.

- A)** When **not** using the basketball system as one of your net posts position your anchors according to the diagram below.

Warning: Do not install your net too close to the basketball system. Leave clearance for the adjustment mechanism if your system is adjustable.

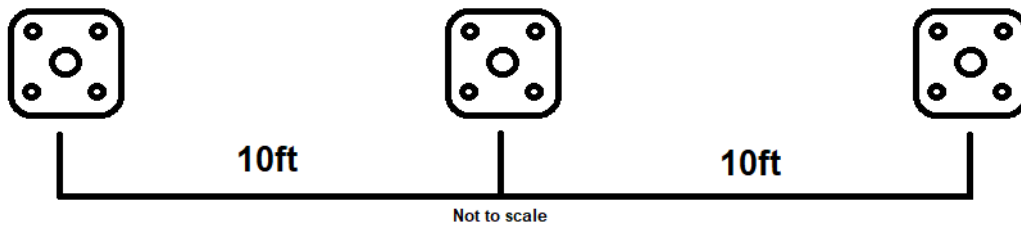

- B)** If use are using the basketball system as one of your posts you need to space your anchors according to the diagram. **This diagram is designed for the 4 anchor bolt systems, Silver, Gold, and Platinum models.**

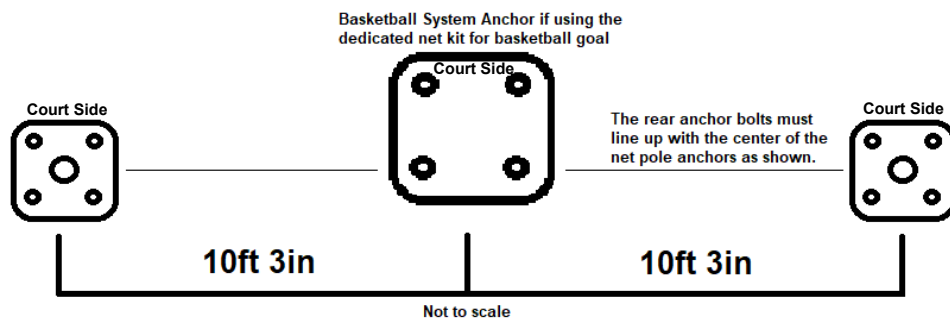

- C)** If use are using the basketball system as one of your posts you need to space your anchors according to the diagram. **This diagram is designed for the 6 anchor bolt Diamond model.**

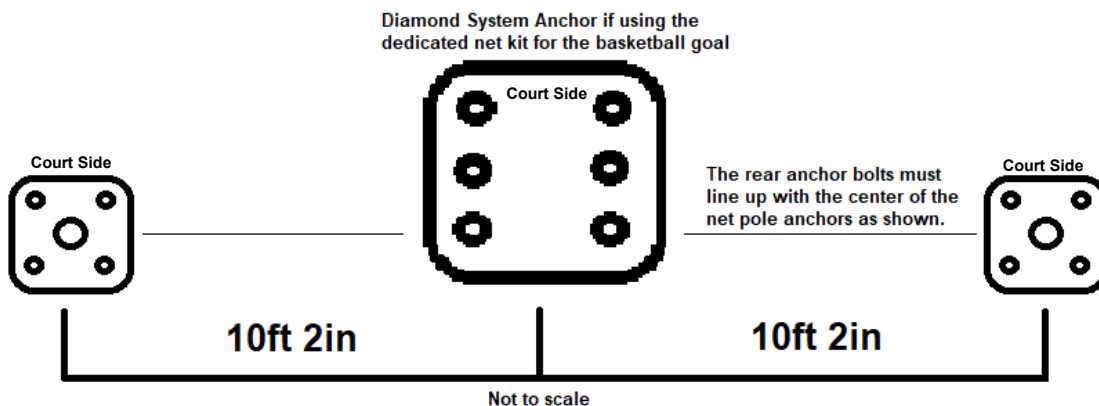

2) Digging Pier Hole

Dig hole 36" deep and 10" square. Be sure to bell out the bottom of the hole 14" to give added stability to the footing. **All anchors must be at the same height and .** You can use a string level or a laser level to insure this.

NOTE: *If you live in an area where the frost line is below 36" it is advisable to dig to normal frost line.*

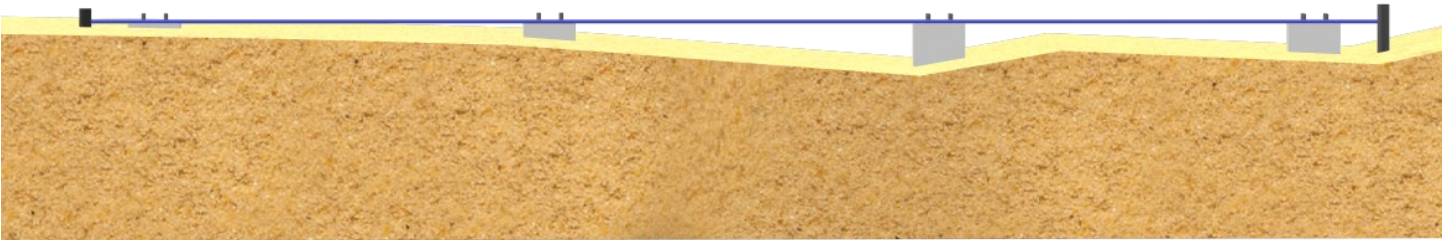
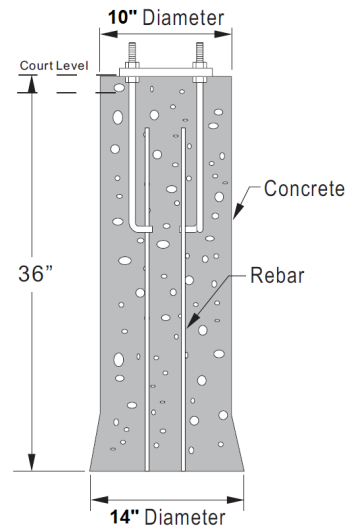

3) Anchor Assembly

Assemble your anchor(s) as shown to the right. You can find the anchor(s) in the boxes labeled "Dedicated Net Pole" or "Dedicated Light and Flag Pole".

NOTE: *There will be (8) flat washers, (4) hex nuts, (4) lock washers, and (4) plastic j-bolt caps left over after the Anchor Assembly. These will be used on the Assembly Day. You can set them to the side for now.*

THESE NUTS
USED FOR
LEVELING

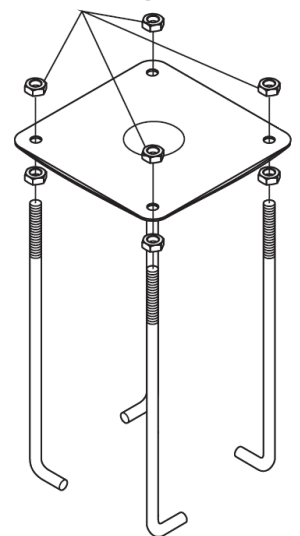

4) Pouring Concrete and Setting Pier Kit

For this step you will need: level, broomstick/shovel and tape measure. The 36" x 10" anchor footing will require roughly 4 80lb bags of concrete or 5 60lb bags of concrete per pier. More will be needed if you dig a larger hole.

NOTE: Make certain that you have enough concrete to finish the job. Allowing a portion to dry while you purchase more concrete will weaken the footing.

Mix (4) 80 lbs. bags of concrete in wheel barrow or cement mixer and pour in pre-dug hole about half full. Agitate concrete with shovel or broomstick to ensure proper fill. Place (4) Pieces of rebar (included) in the middle of the hole about 8 inches apart to create a square in the middle of the hole. All 4 pieces of rebar need to overlap the J-bolts at least 4 inches.

NOTE: Mix concrete to manufacture specifications.

Pour the remaining concrete into the hole until completely full and coming out of the top. Using a trowel, smooth the concrete to your preferred liking. Ensure the top of your concrete is level with any other concrete anchors you are using for our boundary netting.

Place the assembled anchor system in hole to the point where the bottom of the black anchor plate is flush with the top of the finished concrete. Ensure all of your anchors are level with one another as shown in step 2.

NOTE: The (4) Hex Nuts 10 on the bottom of the Anchor Footing Template will be **sacrificed into the concrete.**

Use the level to ensure that the pier anchor template it is level in all directions.

Once completely smooth let the concrete cure. This can take up to a week. Consult the instructions on the concrete bag for curing times and directions.

Day 1 Complete!

Dedicated Net Pole Assembly

Dedicated Net Pole Bill Of Materials

No.	Description	Qty.
1	Bottom Post	1
2	Middle Post	1
3	Top Post	2
4	Anchor Template (Already Installed)	1
5	Rebar (Already Installed)	4
6	Concrete J-Bolt (Already Installed)	4
7	10mm Locknut (8 Already Installed)	12
8	10mm Flat Washer	8
9	10mm Lock Washer	4
10	10mm x 15mm Bolt	2
11	10mm Plastic J-Bolt Cap	4

1) Assemble Dedicated Net Pole

Start by assembling each section of the Dedicated Net Pole together as shown to the right.

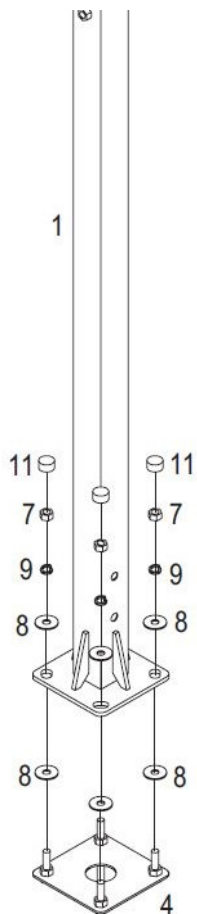
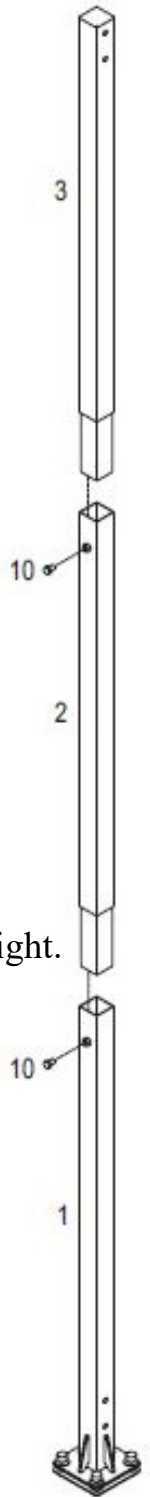

2) Mount to Anchor

Next mount your assembled net pole to your anchor making sure the #10 bolt is facing away from the playing area. Be sure to tighten all bolts and nuts.

If the net pole needs to be leveled you can use the #7 hex nuts underneath the net pole to level the net pole. Raise and lower as needed to fully level the net pole.

Dedicated Light/Flag Pole Assembly

Dedicated Light/Flag Pole Bill Of Materials

No.	Description	Qty.
1	Bottom Post	1
2	Middle Bottom Post	1
3	Middle Top Post	1
4	Top Post	1
5	LED Lamp Bar	1
6	Pole Padding	1
7	Anchor Template (Already Installed)	1
8	Rebar (Already Installed)	4
9	Concrete J-Bolt (Already Installed)	4
10	10mm Locknut (8 Already Installed)	12
11	10mm Flat Washer	8
12	10mm Lock Washer	4
13	8mm x 4cm Hex Bolt	2
14	8mm x 1.5cm Hex Bolt	14
15	8mm Locknut	2
16	8mm Flat Washer	18
17	8mm Lock Washer	2
18	Rubber Power Cord Plug	1
19	10mm Plastic protective sleeve	4
20	Zip Tie	4

1) Assemble Dedicated Net Pole

Start by assembling each section of the Dedicated Light/Flag Pole together as shown to the right.

Skip to step 3 if this is only a flag pole and not an light.

If this is going to be used as a Dedicated Light you will want to fish your power cable through the 4 sections of pole starting at the round hole near the top of the Dedicated Light Pole. Your LED lamps will be located in a separate box with the power cord pre-installed.

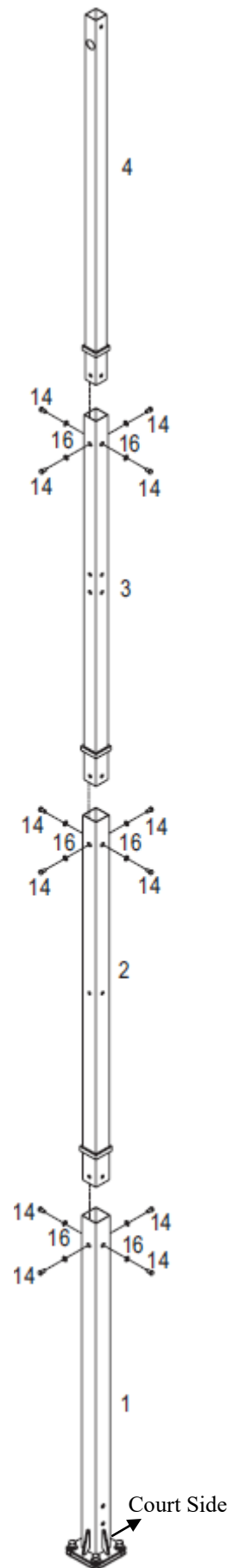

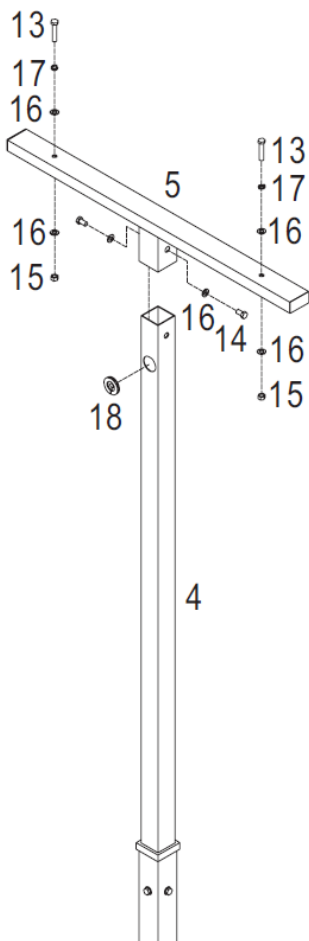

2) LED Lamp Bar Assembly

If using as an Dedicated Light mount the LED Light bar and shown to the left. You will use #13, #17, #16, and #15 to mount your two LED lamps. You can mount the lamps on the top of the LED bar or the Bottom depending.

Once in place you can use the zip ties to secure your power cable.

Continue to the next step only if you purchased the Flag Kit. Otherwise skip to step 5.

Flag Kit Bill Of Materials

No.	Description	Qty.
21	Pulley	1
22	Cleat	1
23	Rope	1
24	Flag Snap Clip	2
25	American Flag	1
26	8mm x 7.5cm Hex Bolt	1
27	8mm Locknut	1
28	8mm Flat Washer	2
29	Square Plastic Cap	1

3) Flag Kit Assembly

Flag Pole and Light Pole Combo

Next remove hex bolt #14 and washer #16 and install #21 Pulley to the desired side of the flag pole. Then using #26, #27, and #28 install the #22 Cleat to the pole on the same side as the #21 Pulley.

Only a Flag Pole

Next install #29 Square Plastic Cap at the top of the pole to keep water out. Then install #21 using #14 and #16 to the desired side of the flag pole. The pulley will fit loosely. Tighten #14 until snug. Then using #26, #27, and #28 install the #22 Cleat to the pole on the same side as the #21 Pulley.

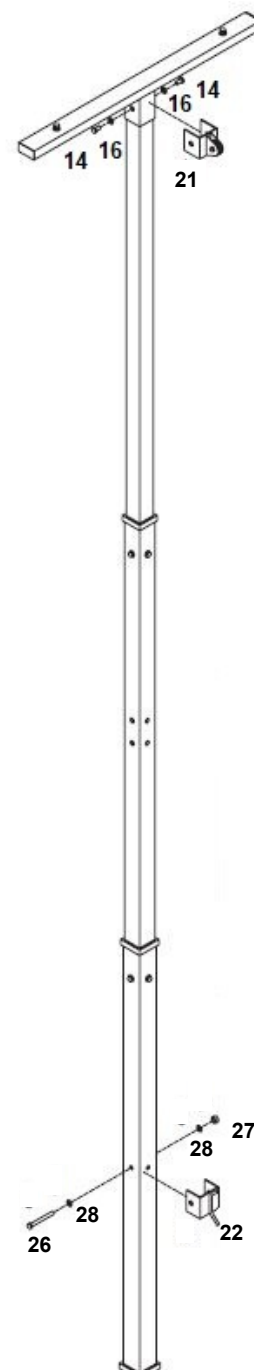

4) Rope and Flag Assembly

Loop your #23 Rope around the #21 Pulley and tie the two ends together. Then wrap the rope around your #22 Cleat. Then right below your knot attach the #24 Flag Snap Clip using the diagram knot diagram to the right.

Then either using the temporary #25 American Flag or the flag of your choosing measure down from your first #24 Flag Snap Clip and attach the second #24 Flag Snap Clip.

SLIP A LOOP
THROUGH THE EYE
OF THE SNAP

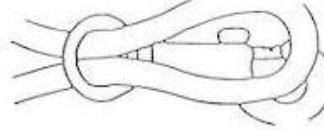

PUT THE LOOP
OVER THE SNAP

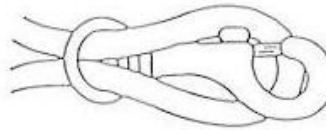

DRAW TIGHT

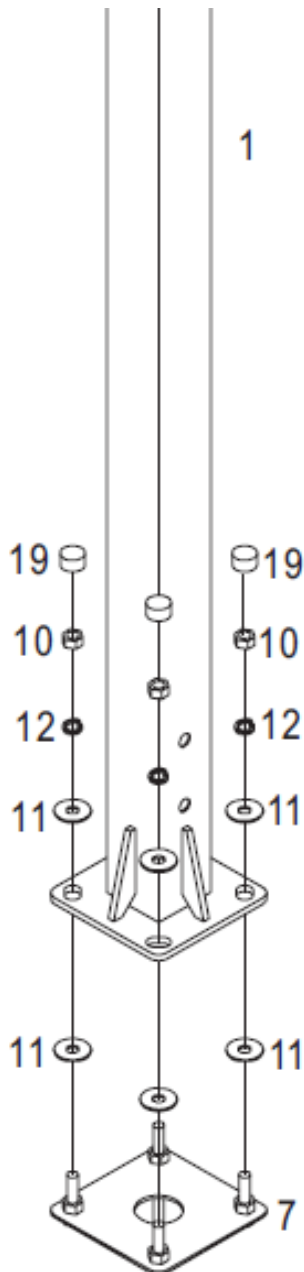
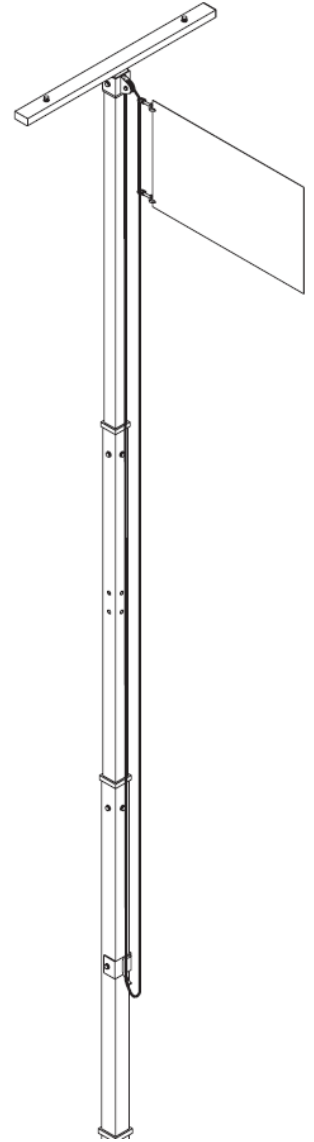
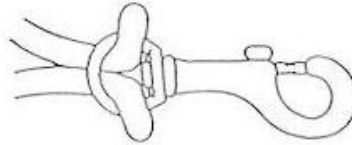

5) Mount to Anchor

Next mount your assembled light/flag to your anchor. Be sure to tighten all bolts and nuts. If you have the Flag Kit be sure the #22 Cleat is facing away from the playing area.

If the net pole needs to be leveled you can use the #12 hex nuts underneath the light/flag pole to level the light/flag pole. Raise and lower as needed to fully level the light/flag pole.

You can now attach your #6 Pole Padding and #25 American Flag.

Dedicated Net Kit For Basketball Goal Assembly

Dedicated Net Kit For Basketball Goal Pole Bill Of Materials

No.	Description	Qty.
1	T bracket	1
2	Pole Bracket	1
3	Anchor Bracket	2
4	10mm x 1.5cm Hex Bolt	2
5	10mm x 4cm Hex Bolt	4
6	10mm Flat Washer	4
7	10mm Lock Washer	4
8	HERCULES Spacer Sleeve	4

1) Pole Bracket Assembly

Pro Dunk THOR and APOLLO **Skip below for HERCULES**

Install #2 bracket to the backside of your main pole using the provided hardware shown to the left. Next slide #1 T Bracket into the #2 Bracket and secure using #4 Hex Bolts.

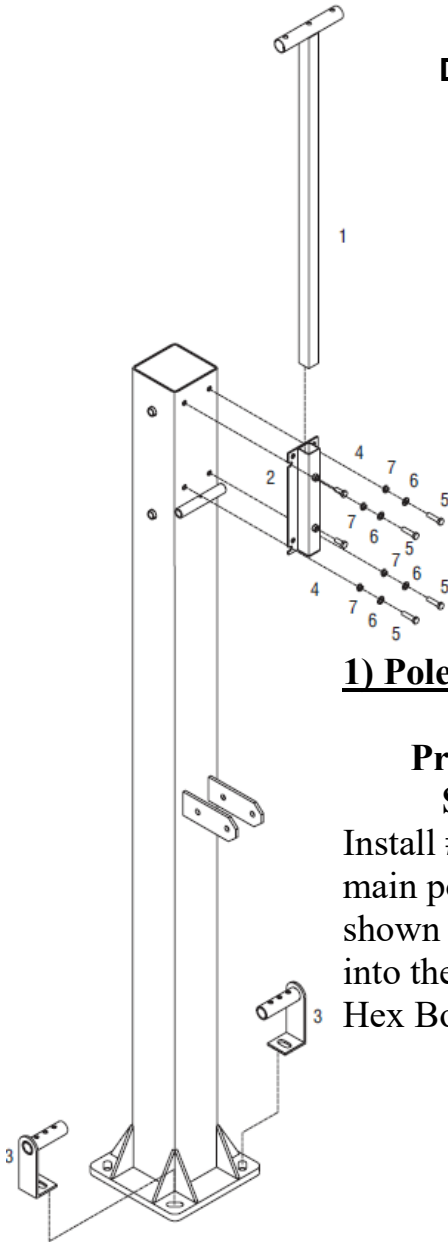

Pro Dunk HERCULES

Install #2 bracket to the backside of your main pole using the provided hardware shown to the right. Next slide #1 T Bracket into the #2 Bracket and secure using #4 Hex Bolts.

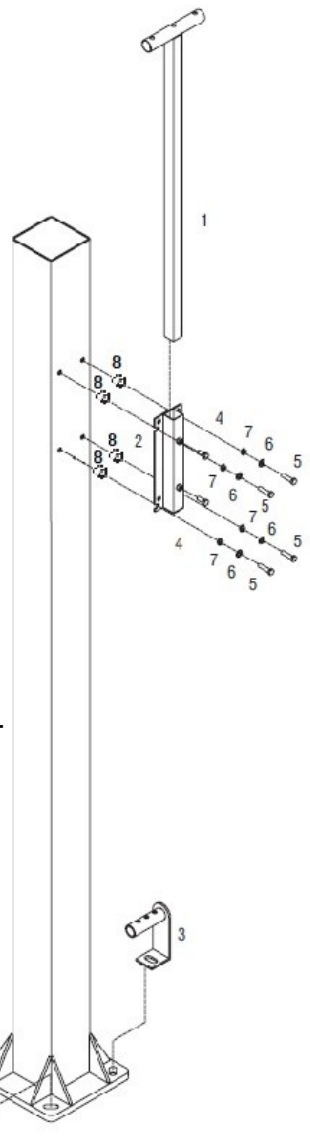

2) Anchor Bracket Assembly

Install #3 Anchor Bracket to the rear anchor bolts as shown.
Only install 1 bracket at a time to avoid the basketball system from falling over.

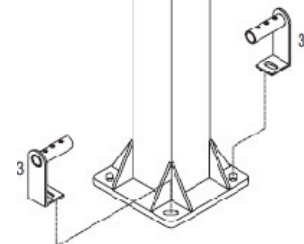

Dedicated Net Assembly

1) Assemble Crossbeams

Thread #1 and #2 Crossbeams together and install on the top and bottom of the #3 Net.

Dedicated Net Bill Of Materials

No.	Description	Qty.
1	Small Crossbeam	2
2	Large Crossbeam	2
3	Net	1
4	Small Connecting Bracket	2
5	Large Connecting Bracket	2
6	Large 90 Degree Connecting	2
7	10mm x 8cm Hex Bolt	2
8	10mm x 7cm Hex Bolt	8
9	10mm x 5cm Hex Bolt	4
10	10mm Locknut	12
11	10mm Flat Washer	24
12	Zip Tie	14

2) Assemble Connecting Brackets

Using an 8ft ladder connect the #4 and #5 connecting brackets as shown. If you are connecting 2 sets of nets together or making a 90 degree turn make sure to install the proper connecting bracket to the other side of the pole as shown below. #7 Hex Bolt is longer and used when assembling more than one connecting bracket at a time.

Each connecting bracket is either a large diameter or a small diameter #4 and #5. Be sure to alternate these across from each other because each net crossbeam will have one side that fits into #4 and one side that fits into #5.

With two adults on 8ft ladders install the top bar of your net as shown using the #9, #10, and #11. Expand or contract the crossbeams to line up the holes to insert hex bolt #9. Repeat this step for the lower crossbeam.

Using the #12 zip ties connect the sides of the net to each pole system. Be sure not to pull the next too tight.

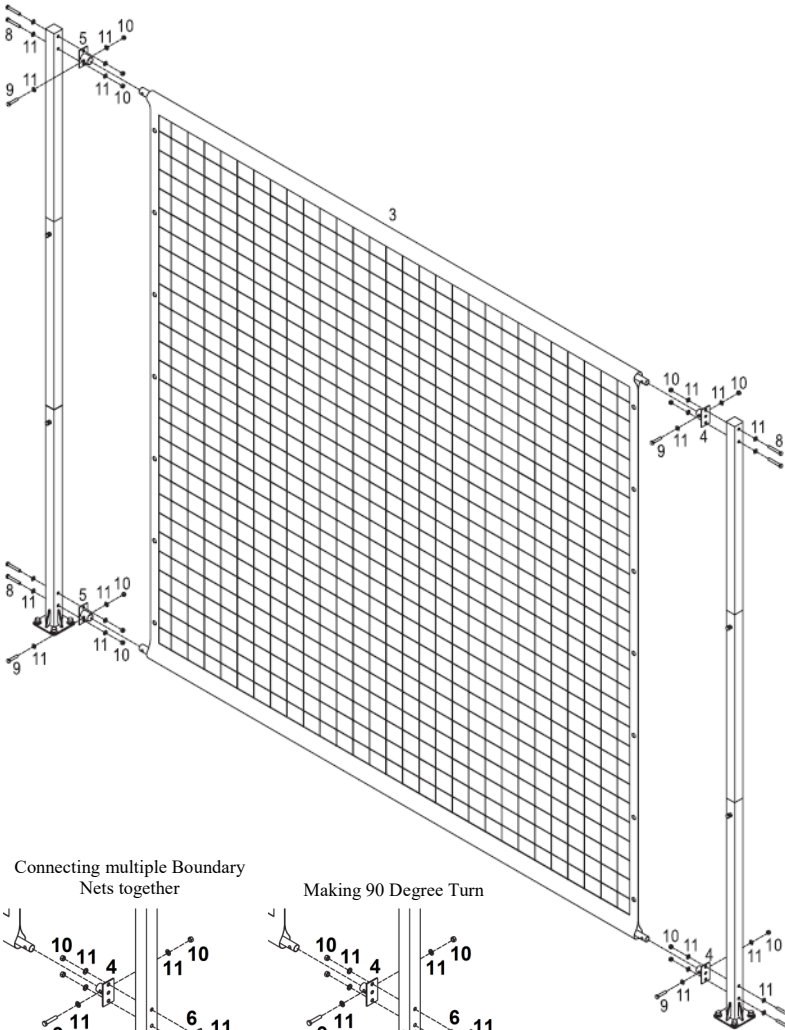
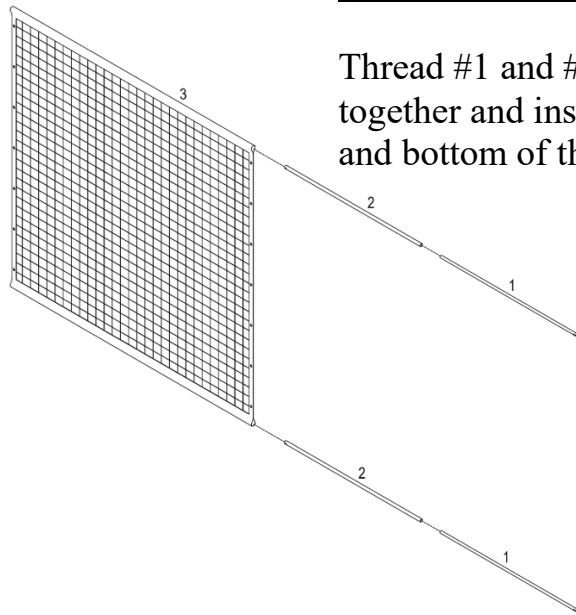

7) Maintenance

Like any piece of hardware, proper maintenance is required. Several factors such as the environment, organic materials, herbicides, pesticides, excessive use or misuse can eventually cause the Goal Light to require maintenance. Failure to do so could result in system failure, property damage, or even personal injury.

- 1) All organic materials should be kept away from the Boundary Netting system at all times. This will alleviate any chance of rust penetrating the powder coated finish and causing structural damage.

Examples: grass clippings, moisture, garbage, dirt, etc.

- 2) If you see any signs of rust on the Boundary Netting system remove the loose paint, sand the area with a medium grit sandpaper and apply outdoor enamel to the affected area.

Suggested Touchup Paint: Rustoleum Semi-Gloss Black Enamel

- 3) **Never leave the LED Lamps plugged in when not in use.** This could result in damage to the Light and can be a fire hazard. When the LED Lamps are no longer in use unplug the light and store your extension cord inside.

- 4) Never use your Boundary Netting during or after precipitation.
-

8) Routine System Inspection

Before each use inspect the entire system for any signs of loose nuts and bolts, any excessive wear and tear, any signs of rust or corrosion.

If replacement parts are needed you can contact Pro Dunk® directly or navigate to www.produnk.com/parts to purchase parts for your Boundary Netting. Only parts provided by Pro Dunk® should be used for repair. Not doing so could cause the system to fail resulting in injury or death and voids the limited warranty.

Hoops Inc. Boundary Netting 90 Day Warranty

Hoops Boundary Netting systems are warranted to the original purchaser to be free from defects in material or workmanship for 90 days of ownership by the original retail purchaser. The word "defects" is defined as imperfections that impair the use of the product.

Warranty Fulfillment

Merchandise must be shipped prepaid with a copy of proof of purchase to Hoops Inc. for examination to see whether it needs to be repaired or replaced. Any labor costs, travel expenses and any other changes involved in the removal, installation or replacement of the defective/repared parts from/to your Hoops Boundary Netting system will be your (the purchaser's) responsibility. Shipping charges for replaced or warranted merchandise being sent back to the customer must be prepaid by the customer in advance. If not, the replacement shipment will be sent out collect. Hoops Inc. reserves the right to examine photographs or physical evidence of merchandise claimed to be defective, and to recover said merchandise, prior to authorization of warranty claims.

What is not covered by this warranty

This warranty does not cover defects or damage due to improper installation, shipping, handling, alteration, accidents, vandalism, weather conditions (rusting), exposure to corrosives, negligence, misuse (anything other than a type of basketball activity or related contact with the unit), scratching, scuffing, discoloration or any event beyond the control of the Hoops Inc.. If unit is not maintained as stated in the user manual the warranty will be void.

Liability

Hoops Inc. shall not be liable for indirect, special, or consequential damages arising out of or in connection with the use or performance of the products or other damages with respect to any economical loss, loss of property, loss of enjoyment of use, costs of removal, installation or other consequential damages for breach of any expressed or implied warranty on these products.

Guidelines

Keep your proof of purchase (original retail purchaser). Without it, we will not be able to proceed with any warranty service.

Call

1-888-600-8545 / Warranty Dept.

Write

Hoops Inc.
Attn: Warranty Dept
22047 Lutheran Church Rd.
Tomball TX 77377

Email

support@hoopsincorporated.com

For the most up to date warranty information please navigate to www.produnk.com.