

# OWNER'S MANUAL



## Warning

- ! Do not slide, climb, or play on pole.
- ! Keep organic material away from pole base. Grass, litter, etc. could cause corrosion and /or deterioration.
- ! Check pole system twice a year for signs of corrosion (rust, pitting, and chipping). Remove rust and/or loose paint completely and repaint with exterior enamel paint. If rust has penetrated through the steel anywhere, replace pole immediately.
- ! Check unit before each use for loose hardware, excessive wear, and signs of corrosion and repair before using.
- ! During play, use extreme caution to keep players face away from the backboard, rim, and net.
- ! Wear a mouth guard when playing to avoid dental injuries.
- ! When adjusting height, keep hands and fingers away from moving parts.
- ! During play, do not wear jewelry (rings, watches, necklaces, etc.). Objects may entangle in net.



# APOLLO<sup>TM</sup>

## Pro Dunk®

### Basketball System

## WELCOME TO THE FAMILY OF PRO DUNK® OWNERS

Thank you for purchasing our basketball system. We try hard to ensure that our products are of high quality and free of manufacturing defects and of missing parts. However, if you have any problems with your basketball pole, such as a manufacturing defect or a missing part please contact us at the following:

**Toll Free:** 1.888.600.8545

**Pro Dunk®**

**Web:** [www.produnk.com](http://www.produnk.com)

22047 Lutheran Church Rd.

Tomball, TX 77377

Please provide model number, serial number, and/or part number of the product and/or part when you call, write or email. These numbers can be found on the product, packaging, or on the back of the main pole.

**Purchase Parts:** [www.produnk.com/parts](http://www.produnk.com/parts)

**Support:** [www.produnk.com/support](http://www.produnk.com/support)

***Read this manual all the way through before starting to put up your system. Then read each step completely before beginning installation.***



**Know what's below.  
Call before you dig.**

**[www.Call811.com](http://www.Call811.com)**

# Bill Of Materials

No.	Description	Qty.
1	Bottom Post	1
2	Top Post	1
3	Upper Board Arm	2
4	Lower Board Arm	1
5	Backboard	1
6	Rim	1
7	Rim Cover Plate	1
8	Post Ear	2
9	Actuator	1
10	Anchor Template <b>(Needed 1st Day)</b>	1
11	Backboard Pad Right	1
12	Backboard Pad Left	1
13	Pole Pad	1
14	Actuator Handle	1
15	Rebar <b>(Needed 1st Day)</b>	4
16	"J" Bolt (Anchor Bolt) <b>(Needed 1st Day)</b>	4
17	12mm x 40mm Bolt	1
18	10mm x 175mm Bolt	3
19	10mm x 165mm Bolt	1
20	10mm x 120mm Carriage Bolt	4
21	10mm x 70mm Bolt	4
22	10mm x 60mm Bolt	4
23	6mm x 40mm Bolt	6
24	5mm x 15mm Bolt	4
25	12mm Nylon Locknut	1
26	10mm Nylon Locknut	12
27	16mm Nylon Locknut <b>(Needed 1st Day)</b>	8
28	10mm Hex Nut	4
29	16mm Washer	8
30	12mm Washer	2
31	10mm Washer	26
32	6mm Washer	12
33	5mm Washer	4
34	10mm Lock Washer	4
35	5mm Lock Washer	4
36	Plastic and Steel Rim Spacer	4
37	16mm Plastic Protective Sleeve	4
38	25mm Plastic Stop Spacer	2
39	10mm Plastic Washer	8
40	12mm Plastic Washer	2
41	16mm Nylon Locknut	4
42	6mm Locknut	6

## Assembled Diagram—Use as reference

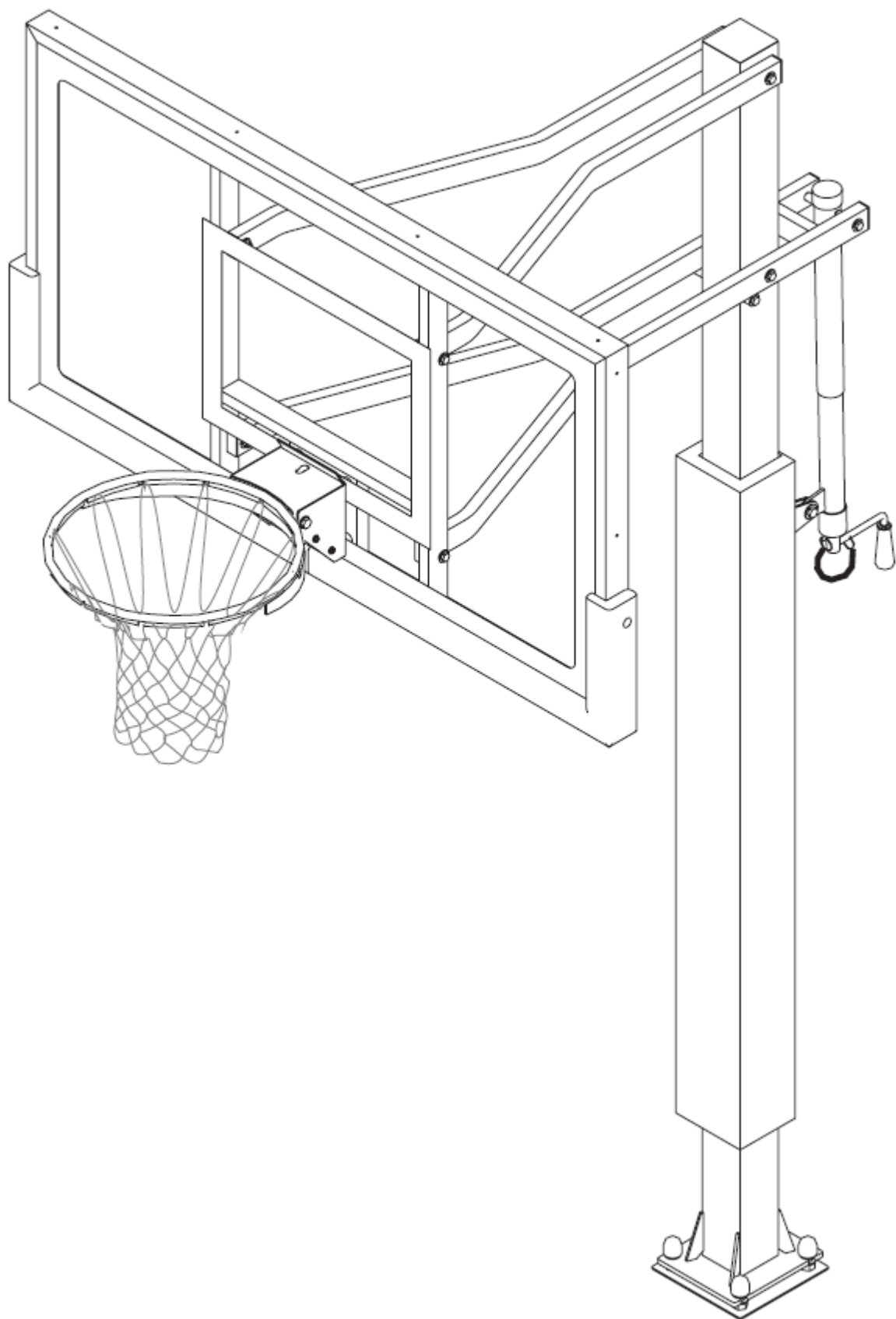

# Safety Instructions



## IMPORTANT

It is the responsibility of purchaser to ensure that all installers and players fully comply with the detailed instructions set forth in this product installation manual. Product assembly should be carried out exactly as instructed and owner supervision of use and installation is required to prevent risk of product malfunction or risk injury.

- All tools used to assemble this product should be used in compliance with manufacturer's guidelines.
- Installation of this product will require heavy lifting and bending. Any person that is not capable of such activity should not participate in the installation of this product.
- If using a ladder during assemble, use extreme caution and refer to the warnings and cautions on the ladder.
- Due to the size and weight of this product, we recommend at least (4) competent adults are present.
- Before digging the hole for the anchor system, please call 811 to ensure that all underground utilities are a safe distance away from the anchor system.
- Make sure there are no overhead power lines within a 25 foot radius of the basketball system.
- All parts and components necessary to complete proper installation are included within this product. Do not use parts not included with our system. Failure to follow this requirement could cause product malfunction and will void warranty of this product.
- Keep all organic materials away from parts and components to avoid corrosion.
- Do not dunk or hang on the rim.
- Do not climb on any part of the basketball system as it was not intended for this activity.

- Do not use the basketball system as a lift or to hoist anything.
- Players should wear protective mouth guard during play to avoid any time of dental injury.
- Players should refrain from wearing any jewelry that could potentially get caught in the rim or net.
- Do not allow children to adjust basketball system.
- Check the basketball system on a regular basis to ensure that there are no signs of deterioration or corrosion, loose hardware, or damaged parts. If you see any signs of damage perform maintenance or contact Pro Dunk® for replacement.
- For maintenance repairs please contact a professional.
- **Failure to follow these safety instructions could result in product malfunction, serious injury, or even death.**

**Pro Dunk®** retains the right to modify this document at any time without notice or obligation.

Keep this installation manual as a reference for your safety and the safety of those playing on the basketball system. Additional copies of these safety instructions are available by calling customer service at **1.888.600.8545** or at **[www.produnk.com](http://www.produnk.com)**

# Installation Overview

In order to have the safest, fun and longest use of your APOLLO™ system, please note and heed the following:

- 1) Prior to goal assembly, call utility services (811) for location of underground utility lines before you dig.
- 2) Immediately unpack all components and cross check against bill of materials. Report any shortages to Pro Dunk® customer service at 1.888.600.8545.
- 3) Parts can be ordered at [www.produnk.com](http://www.produnk.com)
- 4) Assembly is a two part process.

## PART 1

- Day 1.** Complete Anchor System Installation Instructions. (Below)
- Day 2.** Allow concrete to cure.
- Day 3** Allow concrete to cure.
- Day 4.** Allow concrete to cure.

## PART 2

- Day 5.** Complete APOLLO™ assembly instructions.

- 5) For safety measures, have at least 4 capable persons to assist you in assembly of your APOLLO™ Goal.



**Know what's below.  
Call before you dig.**

**[www.Call811.com](http://www.Call811.com)**

**White**—Proposed Excavation

**Pink**—Temporary Survey Markings

**Red**—Electric Power Lines, Cables, Conduit, and Lighting Cables

**Yellow**—Gas, Oil, Petroleum, or Gaseous Materials

**Orange**—Communication, Alarm or Signal Lines, Cables or Conduit

**Blue**—Portable Water

**Purple**—Reclaimed Water, Irrigation and Slurry Lines

**Green**—Sewers and Drain Lines

# Court Layout Diagram

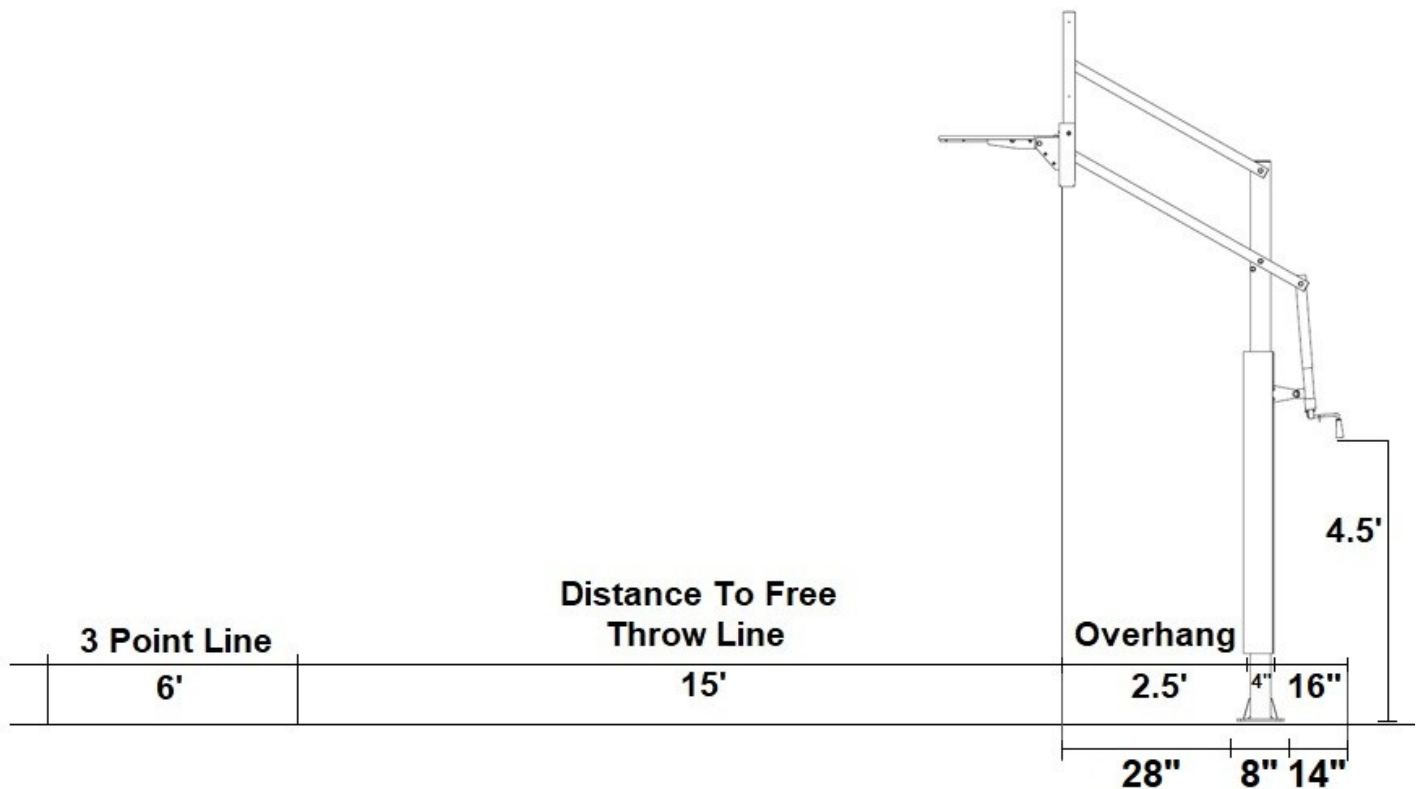

## Required Tools

- Post Hole Digger
- Shovel
- Wheel Barrow
- (9) 80 lbs. bags of concrete OR (12) 60 lbs. bags of concrete
- Trowel
- Level
- Tape Measure
- Box Cutter
- (2) Crescent Wrenches
- (2) Padded Saw Horses
- Phillips Screw Driver
- Ladder
- Block Of Wood
- Optional Wood Form

### Socket/Wrench Sizes Recommended

- 24mm
- 18mm
- 17mm



# Accessories

[https://www.produnk.com/basketball\\_goals/accessories](https://www.produnk.com/basketball_goals/accessories)



Why stop playing in the evening. You don't have to! Order the **Pro Dunk Goal Light LED**. It easily lights up the entire 3-point line with 2 powerful LED lamps extending play into the night. **There's always time for one more game!**

[patent pending 62458721]

Comes with **Free Shipping!**



[Goal Light LED!](https://produnk.com/video/goal_light_led.html)

[produnk.com/video/goal\\_light\\_led.html](https://produnk.com/video/goal_light_led.html)



Catch run away balls from going behind your basketball goal with the **Pro Dunk Backstop Net**. A custom fitted 10.5 feet wide by 7.5 feet tall durable outdoor net stops and rebounds balls back into your driveway.

Comes with **Free Shipping!**



[Backstop Net](https://produnk.com/video/backstop_net.html)

[produnk.com/video/backstop\\_net.html](https://produnk.com/video/backstop_net.html)



Haven't you always wanted your playing area to have regulation striping like a real basketball court. Well now you can with the **Court Marking Stencil Kit**. Just lay it out on your court and applied the included white paint. **Includes the key with side markings, freethrow, and the entire 3-point line.** Fully reusable and a great family DIY project.

Comes with **Free Shipping!**



[Court Marking Stencil](https://produnk.com/video/court_marking_stencil_kit.html)

[produnk.com/video/court\\_marking\\_stencil\\_kit.html](https://produnk.com/video/court_marking_stencil_kit.html)



Customize your pole padding with anything you can think of including family, NBA, college, high school, church or school names. Made of high quality outdoor 3M vinyl. Solid white characters are pre-spaced on transfer paper for easy application to your pole padding.

Comes with **Free Shipping!**



[Custom Pole Pad Lettering](https://produnk.com/video/pole_pad_lettering.html)

[produnk.com/video/pole\\_pad\\_lettering.html](https://produnk.com/video/pole_pad_lettering.html)



# Day 1

## ANCHOR SYSTEM INSTALLATION INSTRUCTIONS



### WARNING

Before digging the hole for this pole, check for buried power, gas, water, and telecommunication lines! Failure to do so could result in serious or fatal injury! Contact your local utility company if unsure.

### 1) Installation Location

Choose the proper location to dig for the concrete footing. Use the distance chart on the previous page to help you make your decision. When choosing the exact position to dig, make sure to maximize the amount of playing surface while minimizing possible driveway obstruction.

### 2) Digging Pier Hole

Dig hole 36" deep and 16" square. Be sure to bell out the bottom of the hole 20" to give added stability to the footing.

**NOTE:** If you live in an area where the frost line is below 36" it is advisable to dig to normal frost line.

**NOTE:** Your steel plate must be as high as or higher than the playing area to ensure the system will adjust to 10ft.

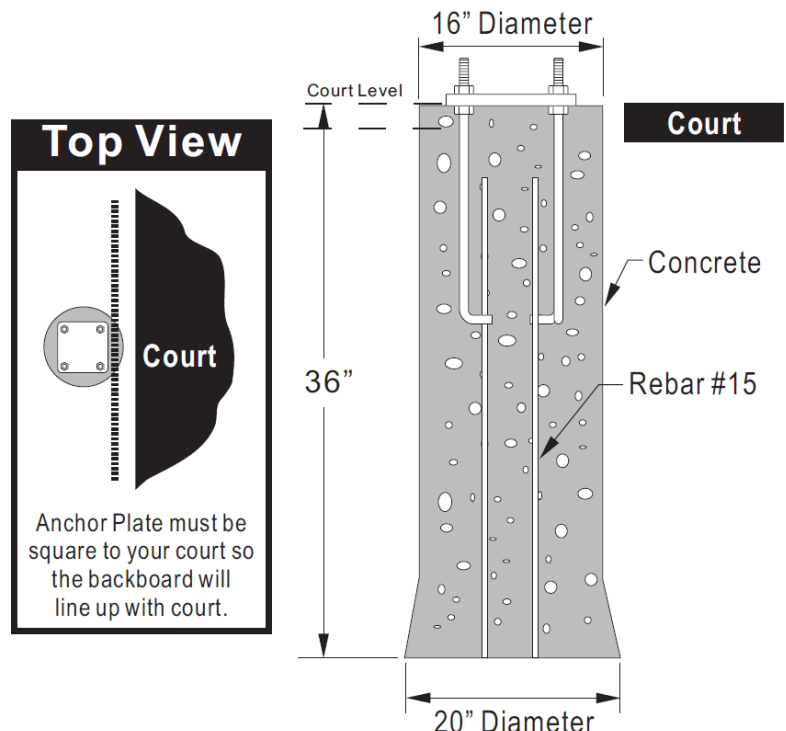



### 3) Anchor Assembly

Twist (4) nuts (#27) to the bottom of threads on (4) J-bolts (#16). Place these J-bolts through the holes on the black anchor plate (#10) and install (4) nuts (#27) and tighten. The bottom of the J-bolts should be positioned as shown.

**Detail A**  
**Bottom View**

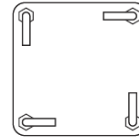

THESE NUTS  
USED FOR  
LEVELING

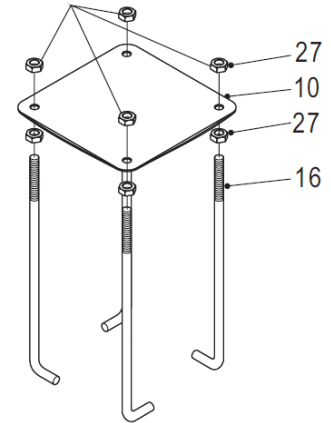

**NOTE:** There will be (8) flat washers (#29) and (4) lock hex nuts (#41) left over after the Anchor Assembly. These will be used on the Assembly Day. You can set them to the side for now.

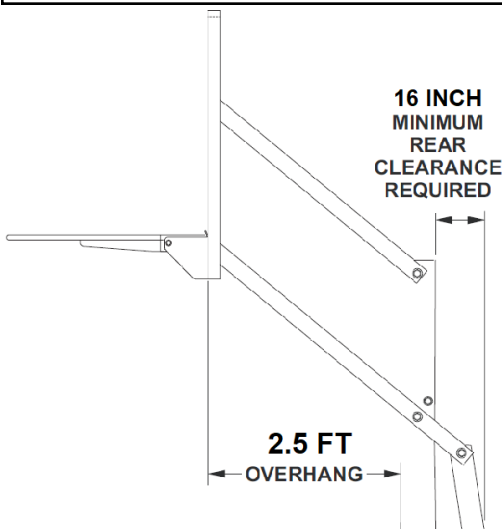

Determine the location of the anchor system. Use the following dimensions as a guide.

The system requires a **minimum of 16 inches** behind the main post to allow for adjustment.

Overhang is defined as the distance between the front of the backboard to the front of the main post when the system is at 10ft. The overhang on the APOLLO is 2.5ft.

### 4) Pouring Concrete and Setting Pier Kit

**NOTE:** Make certain that you have enough concrete to finish the job. Allowing a portion to dry while you purchase more concrete will weaken the footing.

Mix (9) 80 lbs. bags of concrete in wheel barrow or cement mixer and pour in pre-dug hole about half full. Agitate concrete with shovel or broomstick to ensure proper fill. Place (4) Pieces of rebar (#15) (included) in the middle of the hole about 8 inches apart to create a square in the middle of the hole. All 4 pieces of rebar need to overlap the J-bolts at least 6 inches.

**NOTE:** Mix concrete to manufacture specifications.

**NOTE:** The bottom 4 nuts will be forever embedded in concrete. The top 4 nuts remain on bolts and are used for leveling.

Pour the remaining concrete into the hole until completely full and coming out of the top. Using a trowel, smooth the concrete to your preferred liking.



***NOTE: The top of the concrete needs to be **level with or higher than your playing area** to ensure you system will adjust to 10ft regulation height.***

Place the assembled anchor system in hole to the point where the bottom of the black anchor plate (#10) is flush with the top of the finished concrete.

Use the level to ensure that the anchor template (#10) it is level in all directions. Additionally, the center line of the Anchor J-Bolts (#16) must be parallel with the edge of the playing surface.



Once completely smooth let the concrete cure. This can take up to a week. Consult the instructions on the concrete bag for curing times and directions.

**Day 1 Complete!**

# Day ~5

## APOLLO™ ASSEMBLY INSTRUCTIONS



**IMPORTANT!** *Nylon washers adequately space painted parts at all pivot points. Neglecting the use of these washers will result in rusted parts.*

**NOTE:** All board arms are made of rectangular tubing. Tightening hardware too tight may damage tubing and make adjustment of system difficult.

### 5) Connecting Top and Bottom Posts

Before putting any of the poles tubes together, mark bottom pole (#1) 6 inches from the top end.

**Be sure to match up both "Back Side" stickers on the back of the poles.**

### 6) Connecting Top and Bottom Posts

Align the upper pole (#2) with the bottom pole (#1) as shown and slide them together. Stand poles up on a block of wood, lift poles up and hit on a block of wood until the bottom of the upper pole reaches the 6" mark on the bottom pole. Hit poles together a minimum of 7 times. This is a friction-locking joint and requires no hardware.

**IMPORTANT! DO NOT** hit poles with hammer or sledge hammer to slide poles together.

### 7) Attach Post Ears

Attach Post Ears (#8) to holes near the bottom of Top Post (#2) using four bolts (#20) four washers (#31) and four hex nuts (#26).

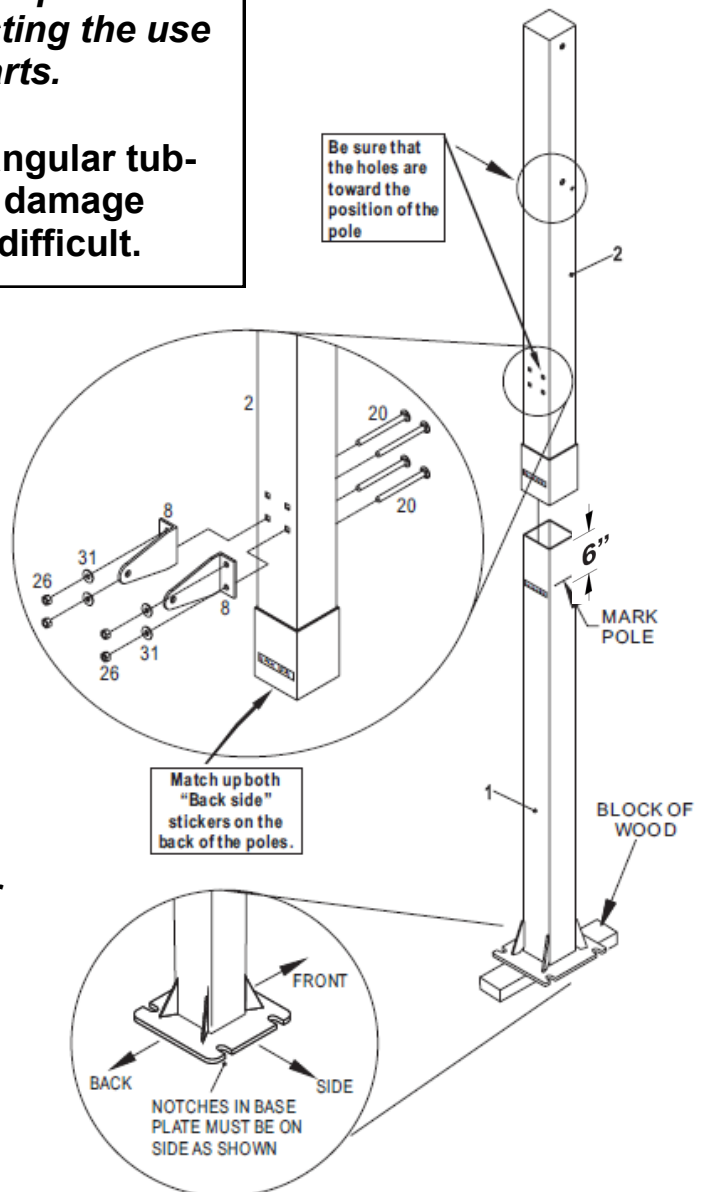

## 8) Actuator Assembly

Lay Pole Assembly on its side on two padded saw horses. Slide tab on Actuator (#9) between Post Ears (#8) and secure using one bolt (#17), two washers (#30), two plastic washers (#40) and one lock nut (#25). Tighten bolts tight.

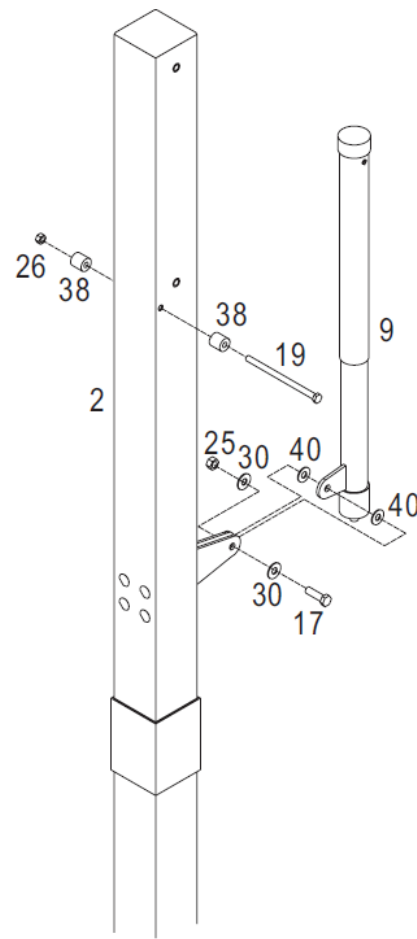

## 9) Safety Stop Assembly

Secure two stop spacers (#38) to pole using one hex bolt (#19) and one lock nut (#26).

## 10) Extension Arm Assembly

Attach lower arms (#4) to Top Pole (#2), using a hex bolt (#18), two flat washers (#31), two plastic washers (#39) and lock nut (#26).

**Note: make sure lettering is right side up.  
DO NOT tighten bolt (#18) at this time.**

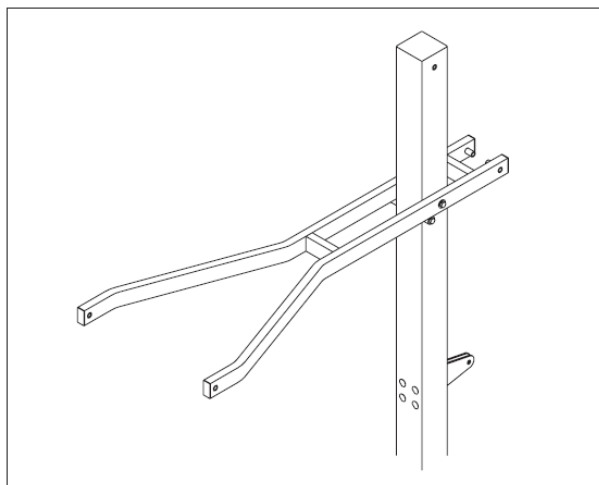
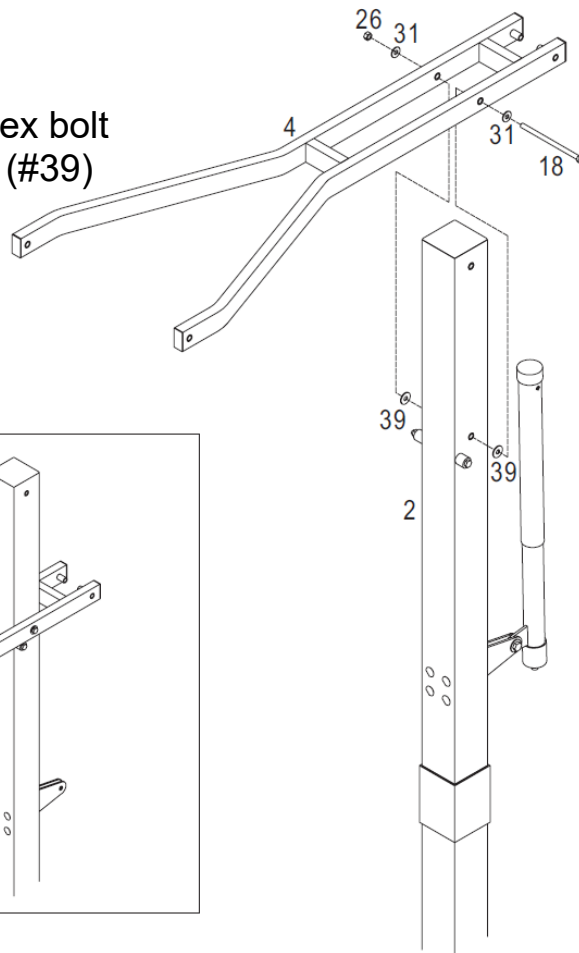

## 11) Assemble Actuator to Post

Secure Actuator (#9) to Lower Arms (#4) using one bolt (#18), two flat washers (#31), and one lock nut (#26). Tighten both bolts (#18) securing Lower Arm (#4).

**Note: Tighten bolts snug but, do not over tighten. Board Arms must pivot freely.**

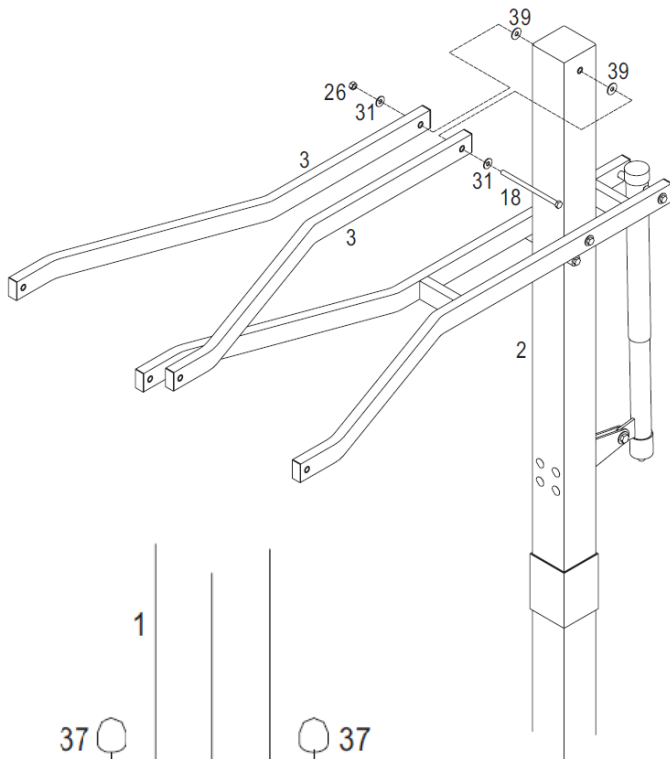
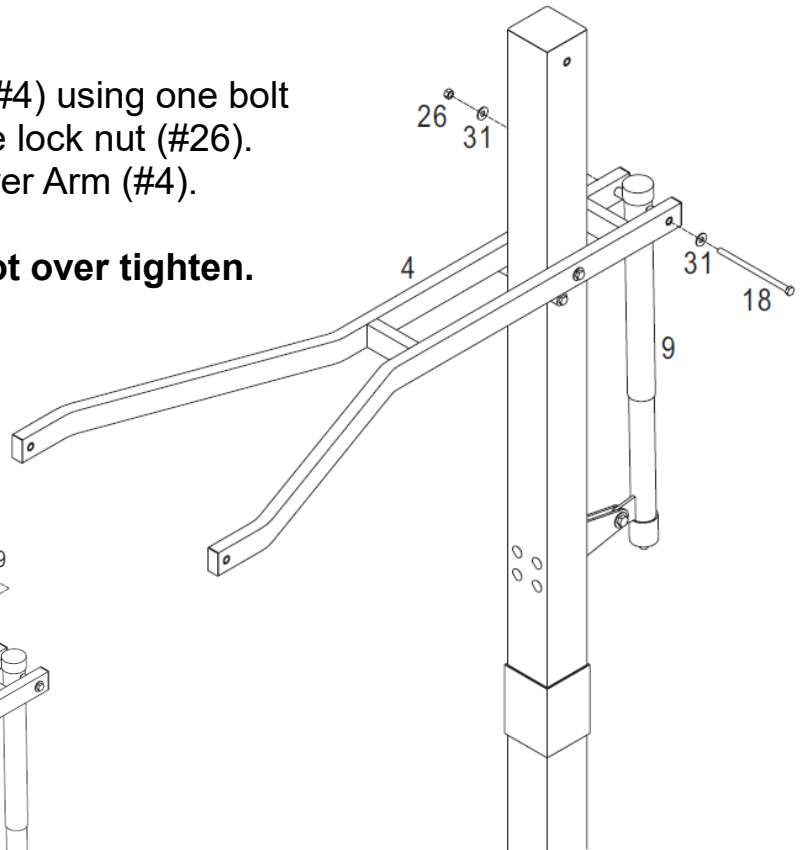

## 12) Assemble Upper Arms

Attach Upper Arms (#3) to Top Pole (#2), using a bolt (#18), two flat washers (#31), two plastic washers (#39) and one lock nut (#26).

**Note: Tighten bolts snug but, do not over tighten. Board Arms must pivot freely.**

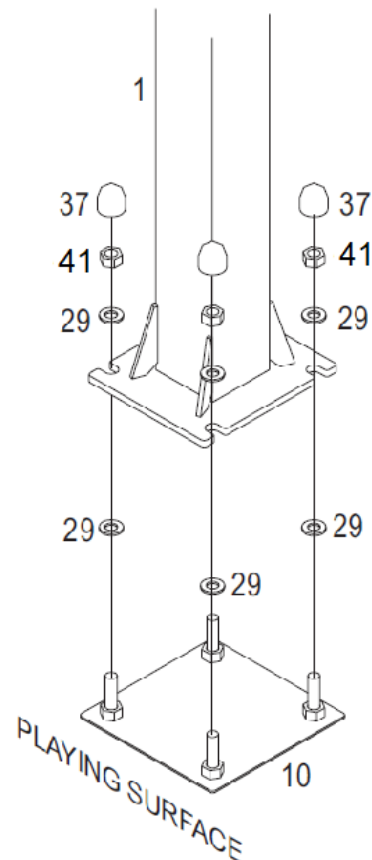

## 13) Mount Pole

Locate hardware needed to mount pole to anchor bolts. You will need, eight flat washers (#29), four locking hex nuts (#41) and four thread protectors (#37).

**Note: Do not remove the nuts you installed in step 3.**

Put a flat washer (#29) on each anchor bolt. Lift post onto anchor system and secure with one flatwasher (#29), and one locking hex nut (#41) for each anchor bolt. Tighten Fasteners finger tight, leave loose enough to level pole. Place a level on pole and adjust bottom nuts (#27) until pole is level. Tighten top four hex nuts (#41) tight. Place a thread protector (#37) on each anchor bolt.



## 14) Actuator Crank Assembly

Slide Actuator Crank (#14) onto shaft on the bottom of Actuator (#9). Line up hole in shaft with hole in Actuator Crank and insert Pin to secure.

To aid in the assembly of the backboard, lower the backboard, by turning the Actuator Crank, until the lower arm makes contact with Stop Spacer (#38).

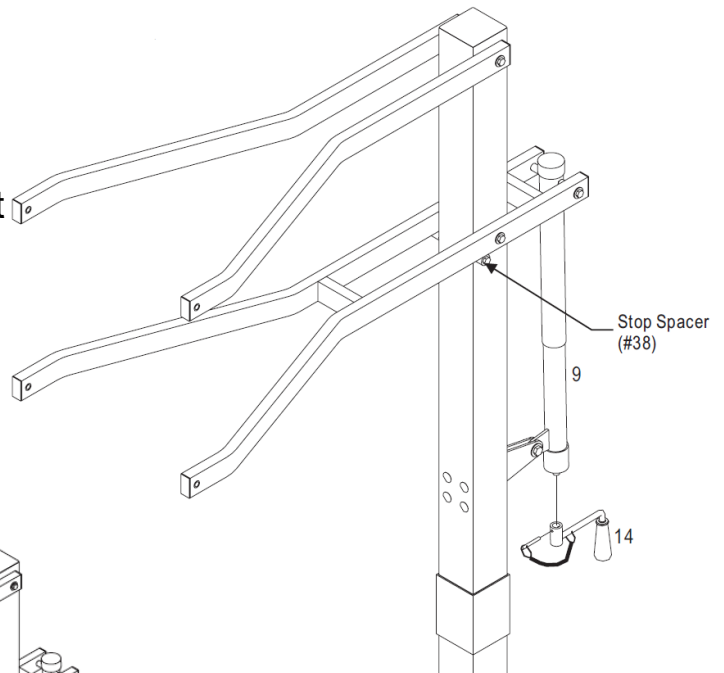

ATTACHING BACKBOARD TO BOARD ARMS  
REQUIRES AT LEAST FOUR CAPABLE ADULTS.

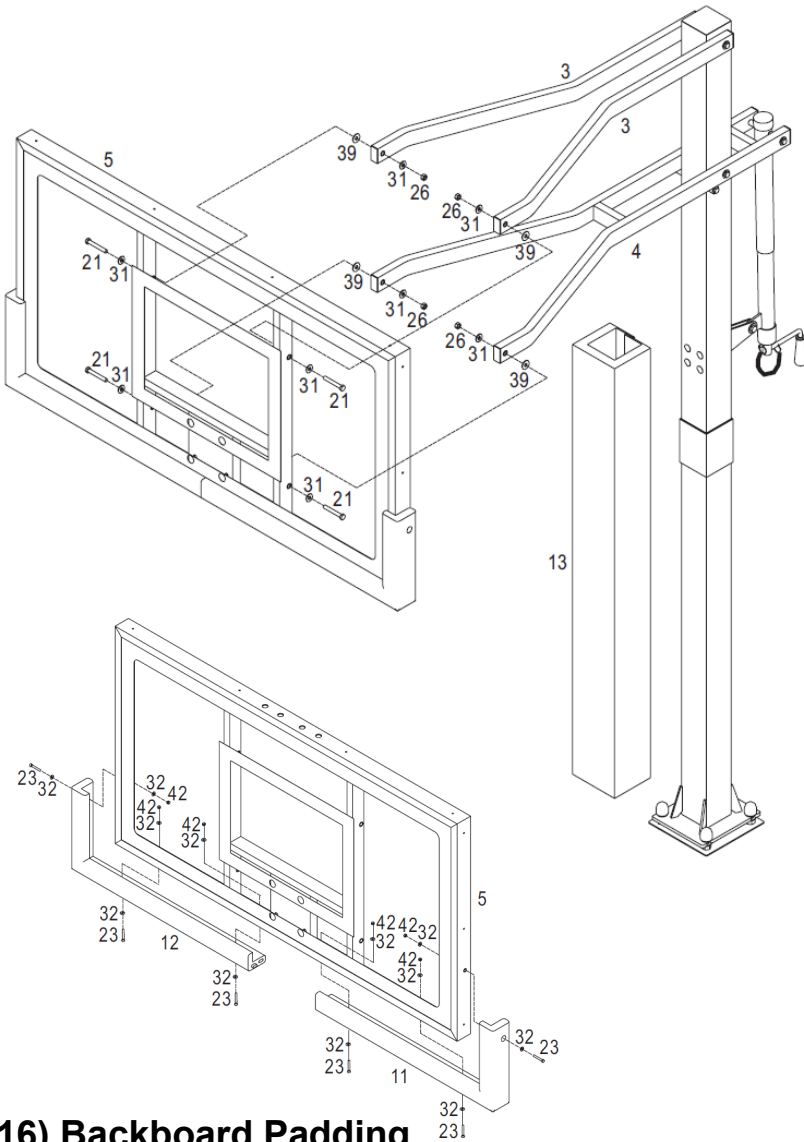

## 15) Backboard Assembly

With at least three capable people, raise the backboard assembly up and have the fourth attach Lower Board Arms to lower mounting tubes on backboard using two bolts (#21), two plastic washers (#39), four washers (#31) and two lock nuts (#26).

**NOTE: DO NOT over tighten these bolts. This is a pivot point. Snug is tight enough.**

Attach Upper Board Arms to upper mounting tubes on backboard using two bolts (#21), two plastic washers (#39), four washers (#31) and two lock nuts (#26).

**NOTE: DO NOT over tighten these bolts. This is a pivot point. Snug is tight enough.**

## 16) Backboard Padding

Using six bolts (#23), twelve washers (#32), six hex nuts (#42) mount backboard padding (#11) and (#12) to backboard (#5).

## 17) Rim Assembly



**CAUTION:** Do not proceed with rim installation without these spacers!

Mount Goal Assembly (#6) and Rim Spacers (#36) to Backboard, using four bolts (#22), eight washers (#31), four lock washers (#34), and four hex nuts (#28). Tighten fasteners finger tight, leave them loose enough to level rim.

**DO NOT FORGET** to assemble four rim spacers (#36) between rim and backboard. **If the rim spacers are not used the backboard will break when rim mounted!**

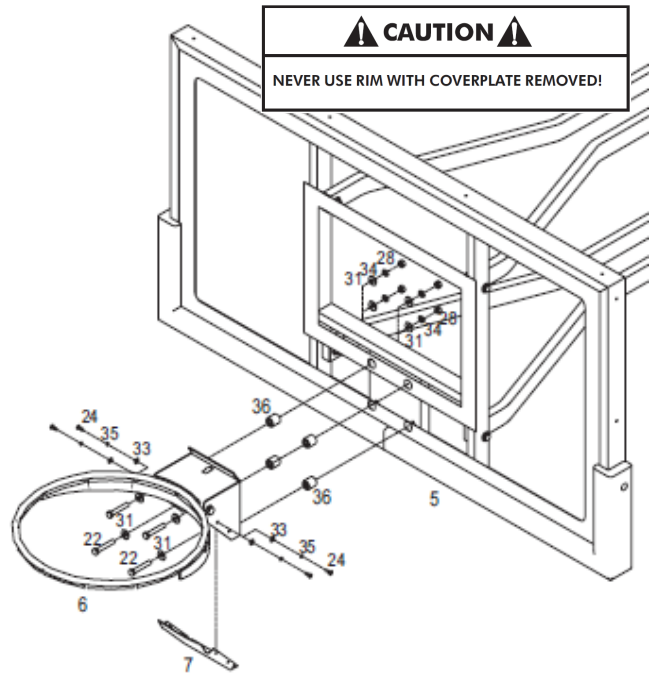

Place a level across rim assembly (#6) and adjust rim until it is level. Finish tightening the four nuts.

Attach Rim Cover Plate (#7) using four washers (#33), four lock washers (#35), and four hex nuts (#24).

Check all nuts and bolts and make sure everything is tightened properly. **DO NOT over tighten pivot points, snug is tight enough.**

If Backboard Padding (#11 and #12) is not pre-installed from the factory use (#23 and #24) hardware to attach to the backboard frame.

## 18) Set Height Meter Sticker

Adjust unit to 7-1/2 feet. Use a tape measure to measure from the top of the rim to the playing surface. Stick Height Decal to back of Actuator with the "7.5" mark aligned with bottom of Black Actuator Sleeve.



**WARNING**

Protruding bolts can cause serious injury. Never use this unit without Pole Pad (#48) firmly in place and covering Post Ear bolts. If Pole Pad is damaged, replace before using this unit.

## 19) Post Pad

Secure Post Pad (#13) to front of pole by wrapping straps around pole and sticking to velcro on opposite side of Pad. Top Post Pad section should be above Post Ears.

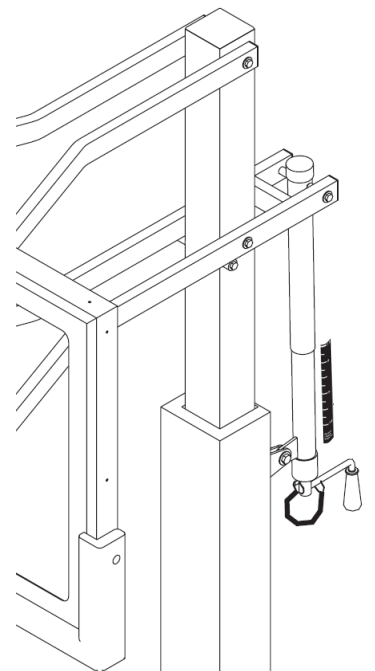



## 20) Maintenance

Like any piece of hardware proper maintenance is required. Several factors such as the environment, organic materials, herbicides, pesticides, excessive use or misuse can eventually cause the basketball system to require maintenance. Failure to do so could result in system failure, property damage, or even personal injury.

- 1) All organic materials should be kept away from the system at all times. This will alleviate any chance of rust penetrating the powder coated finish and causing structural damage.

**Examples:** grass clippings, moisture, garbage, dirt, etc.

- 2) If you see any signs of rust on the system remove the loose paint, sand the area with a media grit sandpaper and apply outdoor enamel to the affected area.

**Suggested Touchup Paint:** Rustoleum Semi-Gloss Black Enamel

- 3) To clean the backboard use a 100% cotton soft cloth with mild dishwashing liquid for soap and luke warm water. Rinse backboard with lukewarm water. Wash gently with a 100% Cotton soft cloth, lukewarm water and mild soap. Do not scrub. Rinse backboard with lukewarm water again. Dry with 100% cotton soft cloth. To minimize scratches and minor abrasions to your backboard

- 4) Never adjust the rim below 7' 6" or over 10'. Adjustments of the goal should be done under adult supervision. When attempting to slam dunk you should always wear a mouth guard to avoid dental injury.

- 5) Replace Net Video—



[Replace Net](https://produnk.com/video/rim_net_replacement.html)

[produnk.com/video/rim\\_net\\_replacement.html](https://produnk.com/video/rim_net_replacement.html)

---

## 21) Routine System Inspection

Before each use inspect the entire system for any signs of Loose nuts and bolts, any excessive wear and tear, any signs of rust or corrosion.

If replacement parts are needed you can contact Pro Dunk® directly or navigate to [www.produnk.com](http://www.produnk.com) to purchase parts for your system. Only parts provided by Pro Dunk® should be used for repair. Not doing so could cause the system to fail resulting in injury or death and voids the limited warranty.

**NOTE:** It is advisable to wait up to two weeks to allow the anchor footing to fully cure before aggressive play.

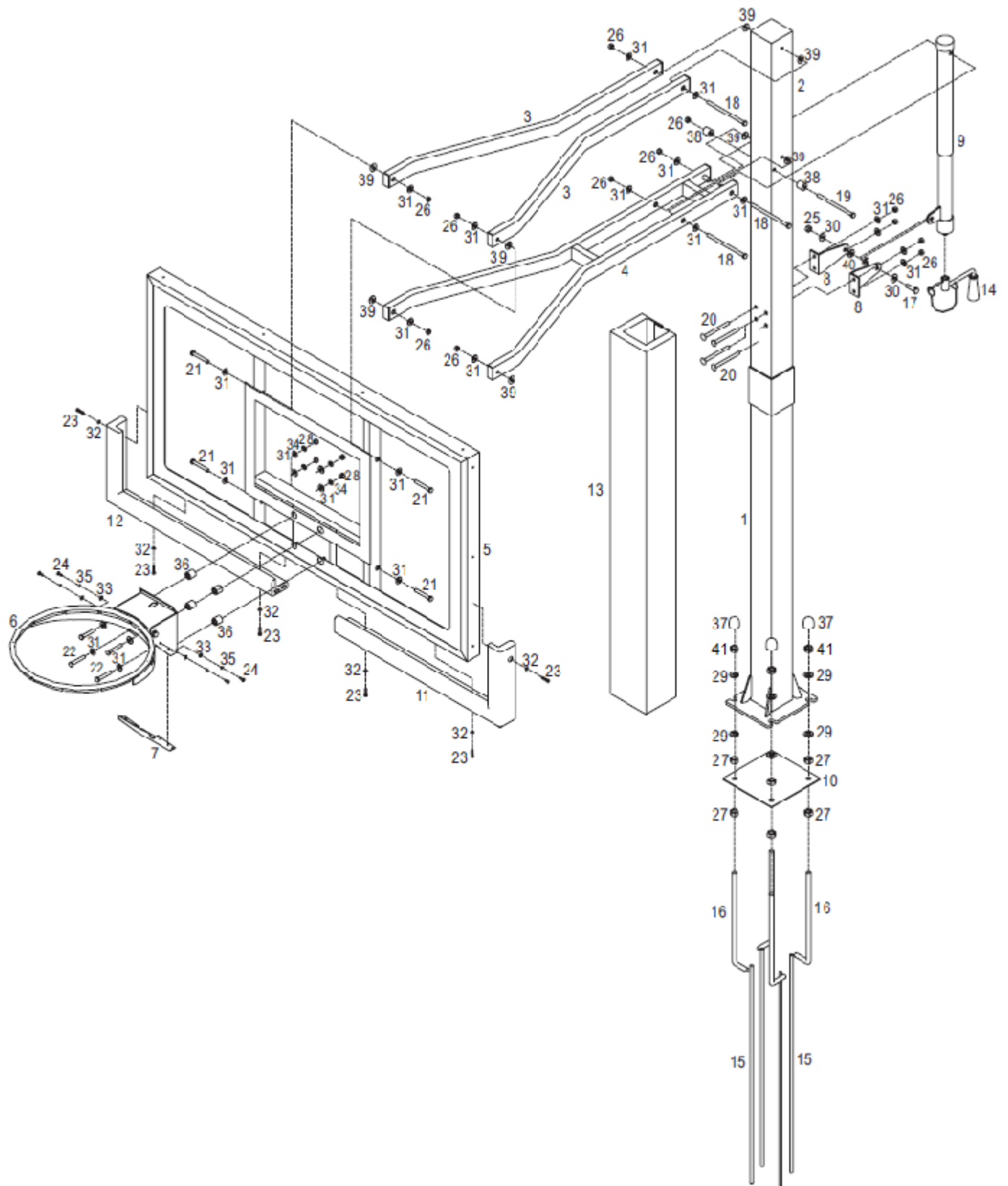

## Hoops Inc. APOLLO™ Limited 5 Year Warranty

Hoops APOLLO™ basketball structural components are warranted to the original purchaser to be free from defects in material or workmanship for the duration of ownership by the original retail purchaser. The word “defects” is defined as imperfections that impair the use of the product.

### Warranty Fulfillment

Merchandise must be shipped prepaid with a copy of proof of purchase to Hoops Inc. for examination to see whether it needs to be repaired or replaced. Any labor costs, travel expenses and any other changes involved in the removal, installation or replacement of the defective/repaired parts from/to your APOLLO™ system will be your (the purchaser's) responsibility. Shipping charges for replaced or warranted merchandise being sent back to the customer must be prepaid by the customer in advance. If not, the replacement shipment will be sent out collect. Hoops Inc. reserves the right to examine photographs or physical evidence of merchandise claimed to be defective, and to recover said merchandise, prior to authorization of warranty claims.

### What is not covered by this warranty

- This warranty does not cover defects or damage due to improper installation, Non-residential use, shipping, handling, alteration, accidents, vandalism, weather conditions (rusting), exposure to corrosives, negligence, hanging on rim, misuse (anything other than a type of basketball activity or related contact with the unit), scratching, scuffing, Acts of God, or any event beyond the control of the Hoops Inc.. If unit is not maintained as stated in the user manual the warranty will be void.
- Paint or rusted parts. If rust should appear, remove loose paint, sand lightly, primer and paint with exterior flat matte finish enamel paint.
- HANGING ON RIM WILL VOID THE WARRANTY: Rims are not warranted for any defects other than workmanship. Torn back plates, damage springs, bent rings, damaged eyebolts, damaged net ties, and torn or distorted rim supports result from hanging on the rim and are not warranted.
- Merchandise not intended to be in places of public assembly, such as, but not limited to, schools, parks, public or private recreational facilities, churches, camps.
- Shipping charges both ways.
- Dealer service charges, labor charges, and travel expenses associated with replacement of repair of warranty item.

### Liability

Hoops Inc. shall not be liable for indirect, special, or consequential damages arising out of or in connection with the use or performance of the products or other damages with respect to any economical loss, loss of property, loss of enjoyment of use, costs of removal, installation or other consequential damages for breach of any expressed or implied warranty on these products.

### Guidelines

Keep your proof of purchase (original retail purchaser). Without it, we will not be able to proceed with any warranty service.

1-888-600-8545/ Warranty Dept.

Write

Hoops Inc.  
Attn: Warranty Dept  
22047 Lutheran Church Rd.  
Tomball TX 77377

Email

[support@hoopsincorporated.com](mailto:support@hoopsincorporated.com)

For the most up to date warranty information please navigate to [www.produnk.com](http://www.produnk.com)